

N TYPE

SCAN CODE TO WATCH VIDEO



Learn more about the production of 182mm Mono PV Module

SKT580~590M10-144D4 580~590 Watt

182mm 16BB 144Cells Double Glass Bifacial
N Type Mono Half Cell PV Module Series

Sunket N Type Linear Warranty

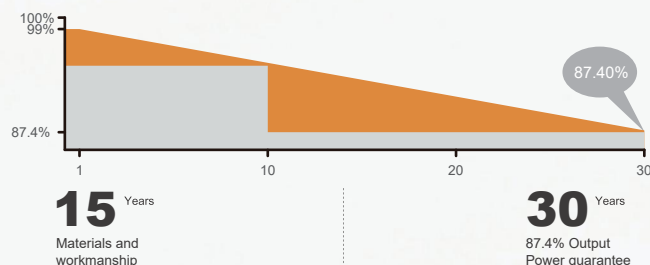

SMBB Technology
Half Cut N Type Cell



High Energy
Performance



100% Inspection
30years Guarantee



Fire Class A



5400Pa
Strengthened
Mechanical Load



Advanced Bifacial
Efficiency



 **SUNKET[®] - Solar**

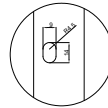
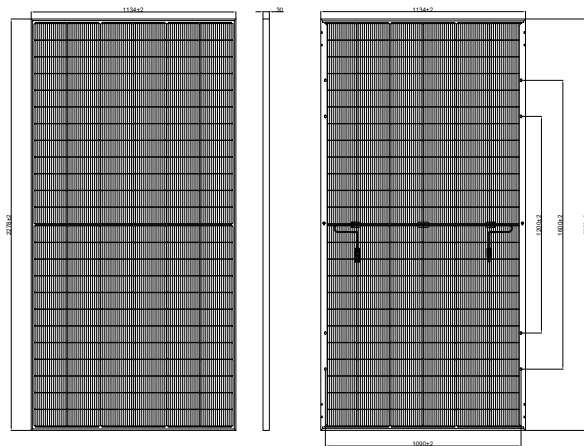

Unit:mm

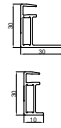

Current-Voltage & Power-Voltage Curves (SKT590M10-144D4)

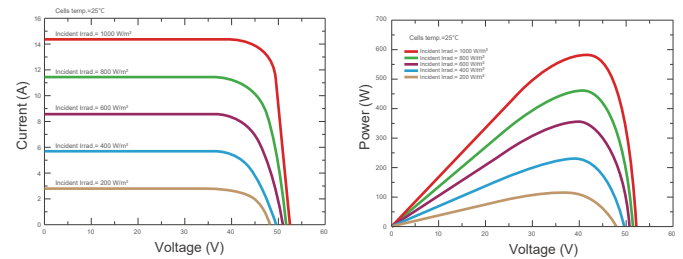

All Dimensions in mm
The above drawing is a graphical representation of the product.

Electrical Characteristics (STC/NOCT)

Module Type	SKT580M10-144D4		SKT585M10-144D4		SKT590M10-144D4	
	STC	NOCT	STC	NOCT	STC	NOCT
Test Conditions						
Maximum Power- Pmax(W)	580	436	585	440	590	444
Open Circuit Voltage - Voc(V)	51.47	48.89	51.67	49.08	51.87	49.27
Short- Circuit Current - Isc(A)	14.37	11.21	14.43	11.26	14.49	11.31
Voltage at Pmax -Vmp(V)	42.60	39.86	42.76	39.97	42.92	40.08
Current at Pmax - Imp(A)	13.62	10.94	13.69	11.01	13.75	11.08
Module Efficiency -ηm(%)	22.45	/	22.64	/	22.84	/
Power Tolerance(W)	(0, +4.99W)					
Maximum System Voltage(V)	1500Vdc (IEC / UL)					
Maximum Series Fuse Rating (A)	30A					

*STC : Irradiance 1000W/m², Cell Temperature 25 °C, Air Mass 1.5
*NOCT : Irradiance 800W/m², Ambient Temperature 20 °C, Air Mass 1.5, Wind Speed 1m/s
*Measurement tolerance: ±3% *Power binning up to: +3%

Mechanical Specifications

External Dimensions	2278×1134×30mm
Weight	31kg
Solar Cells	N-Type 16BB 182mm (2×72pcs)
Glass	AR Coated 2+2 mm tempered glass
Frame	Anodized aluminum alloy
Junction Box	IP68
Output Cables	4.0mm², 1200mm (+), 1200mm (-), length can be customized
Connector	MC4 Compatible
Mechanical Load	Front Side Max. 5400Pa, Rear Side Max. 2400Pa

Temperature Characteristics

Pmax Temperature Coefficient	-0.290%/°C
Voc Temperature Coefficient	-0.250%/°C
Isc Temperature Coefficient	+0.045%/°C
Operating Temperature Range	-40~+85°C
Nominal Operating Cell Temperature(NOCT)	45±2°C

Bifacial Output Rear Side Power Gain

*Take SKT585M10-144D4 as an example.

Power Gain	5%	15%	25%
Maximum Power- Pmax(W)	614	673	731
Open Circuit Voltage - Voc(V)	51.67	51.67	51.67
Short- Circuit Current - Isc(A)	14.81	16.23	17.63
Voltage at Pmax -Vmp(V)	42.76	42.76	42.76
Current at Pmax - Imp(A)	14.36	15.74	17.10

Packing Configuration

Pallet Dimensions	2320×1140×1254mm		
Ways of Transport	40'HQ	13.5m Flatbed Truck	17.5m Flatbed Truck
Pieces per Pallet	37 Pcs	36 Pcs	36 Pcs
Pallets per Container	20 Pallets	17 Pallets	26 Pallets
Pieces per Container	740 Pcs	612 Pcs	936 Pcs